



Homepark House, Farnham, Surrey

Price Guide £90,000

A wonderful town centre 1st floor apartment with direct access onto beautiful, southerly aspect, communal gardens and the River Way.

The Homepark House development is an over 60s retirement living. There is an on-site warden available and 24 hour emergency help. There is a communal sitting room and laundry area and the property is offered with no onward chain.

*Central Farnham Location *One Double Bedroom *Living Room *Shower Room
*Kitchen *Communal Sitting Area And Laundry Room *No Onward Chain

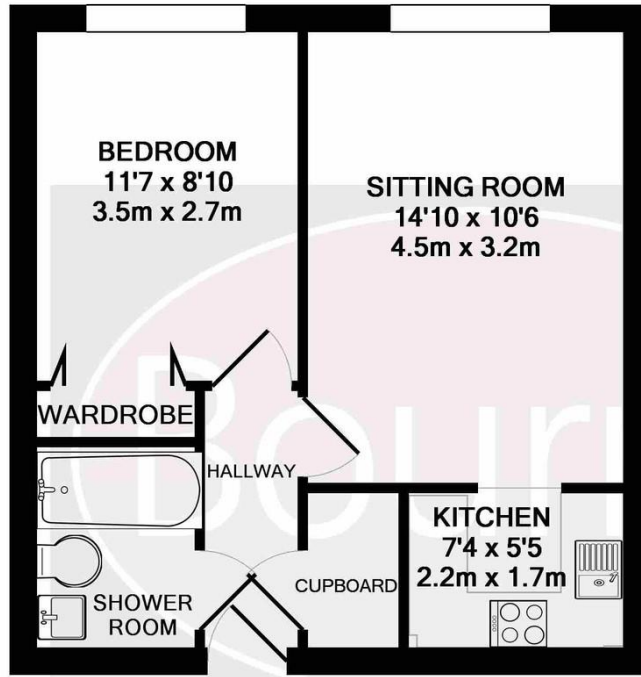

FOR ILLUSTRATIVE PURPOSES ONLY
 TOTAL APPROX. FLOOR AREA 392 SQ.FT. (36.4 SQ.M.)

Whilst every attempt has been made to ensure the accuracy of the floor plan contained here, measurements of doors, windows, rooms and any other items are approximate and no responsibility is taken for any error, omission, or mis-statement. This plan is for illustrative purposes only and should be used as such by any prospective purchaser. The services, systems and appliances shown have not been tested and no guarantee as to their operability or efficiency can be given

Made with Metropix ©2018



Location:

Homepark is ideally situated within the heart of Farnham town centre.

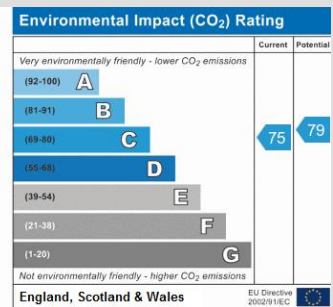
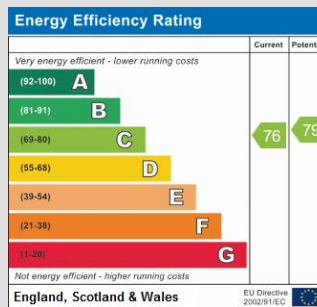

We aim to make our particulars both accurate and reliable but they are not guaranteed, nor do they form part of an offer or contract. If you require clarification of any points then please contact us – especially if you are travelling some distance to view. Please note that appliances and heating systems have not been tested and therefore no warranties can be given as to their good working