



Petersfield, Hampshire

Offers in excess of £425,000

# Petersfield, Hampshire

This two bedroom extended semi detached bungalow is situated in the sought after semi rural village of Steep Marsh which is just outside of Petersfield. This bungalow has been extended and comprehensively modernised by the current owners and now offers contemporary open plan modern living.

As you enter this bungalow there are two double sized bedrooms to the front and a re-fitted bathroom, to the rear is a fantastic open plan lounge/kitchen/diner with vaulted ceilings, a ceiling lantern which allows plenty of natural light in and bi-fold doors opening into the rear garden which really brings the outside in. The property features a woodburning stove.

To the rear is an enclosed rear garden which backs on to paddocks and really completes this idyllic setting. To the front of the property is a patio and parking.

Freehold

- Semi Detached Bungalow
- Two Bedrooms
- Extended
- Re-Fitted Kitchen
- Re-Fitted Bathroom
- Open Plan Living
- Semi Rural Location
- Off Street Parking
- No Onward Chain



# Floorplan

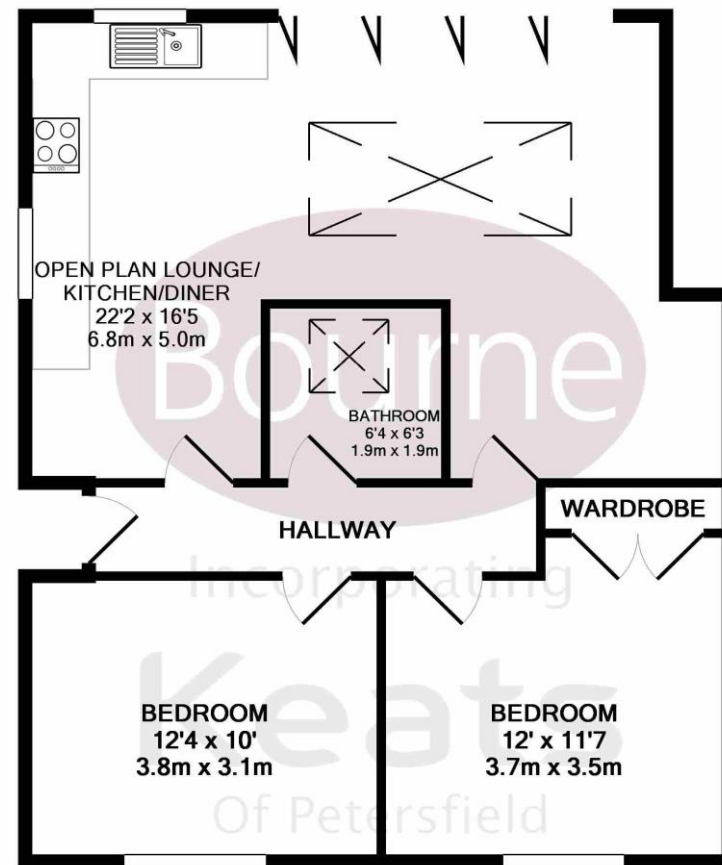

TOTAL APPROX. FLOOR AREA 695 SQ.FT. (64.6 SQ.M.)

Whilst every attempt has been made to ensure the accuracy of the floor plan contained here, measurements of doors, windows, rooms and any other items are approximate and no responsibility is taken for any error, omission, or mis-statement. This plan is for illustrative purposes only and should be used as such by any prospective purchaser. The services, systems and appliances shown have not been tested and no guarantee as to their operability or efficiency can be given

Made with Metropix ©2016

# Location

Situated in the semi-rural village of Steep marsh, approx. three miles from central Petersfield, the mainline train station and its selection of shops and restaurants.

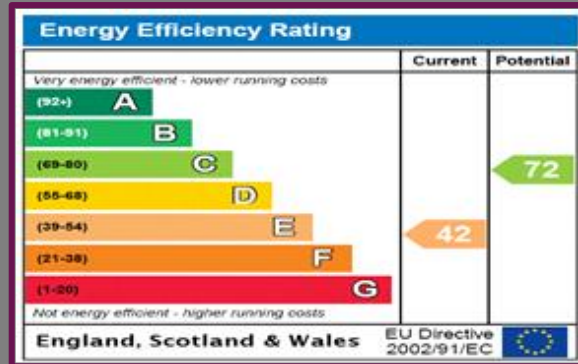
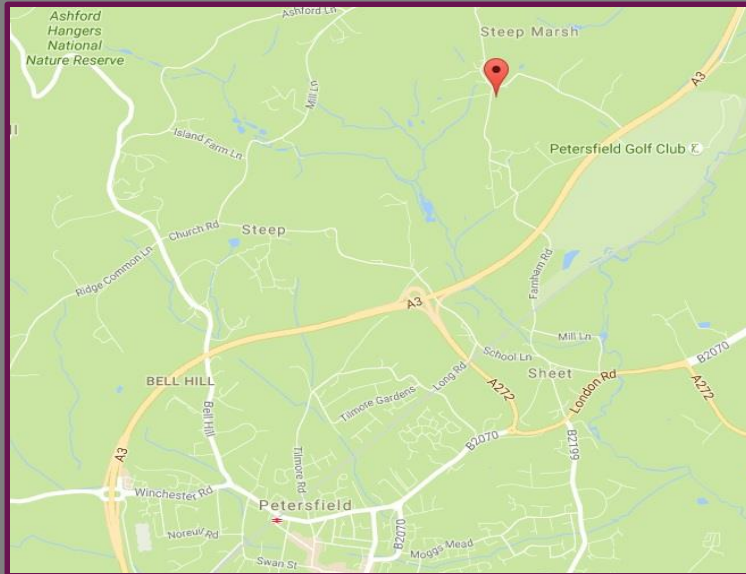

We aim to make our particulars both accurate and reliable but they are not guaranteed, nor do they form part of an offer or contract. If you require clarification of any points then please contact us especially if you are travelling some distance to view. Please note that appliances and heating systems have not been tested and therefore no warranties can be given as to their good working order.



A refreshing choice...

**PETERSFIELD: Swan House, 2 Swan Street, Petersfield, Hampshire, GU32 3AD**

Tel: 01730 262826 | Email: [petersfield@bourneestateagents.com](mailto:petersfield@bourneestateagents.com)

Web: [www.Bourneestateagents.com](http://www.Bourneestateagents.com)