



West Barnes Lane, New Malden, Greater London, KT3 6HR

£1,500 per month



This spacious top floor apartment comes fully furnished and is offering one bedroom, modern kitchen with fitted appliances & family sized bathroom, off road parking and access to rear garden with summer house.

Conveniently located near local amenities, transport links, and green spaces.

- 0.6 Miles to Motspur Park Station
- Zone 4
- Off Road Parking
- One Double Bedroom
- Modern Kitchen & Bathroom
- Furnished
- Access to Rear Garden
- Available April



# Floorplan

TOP FLOOR  
501 sq.ft. (46.5 sq.m.) approx.

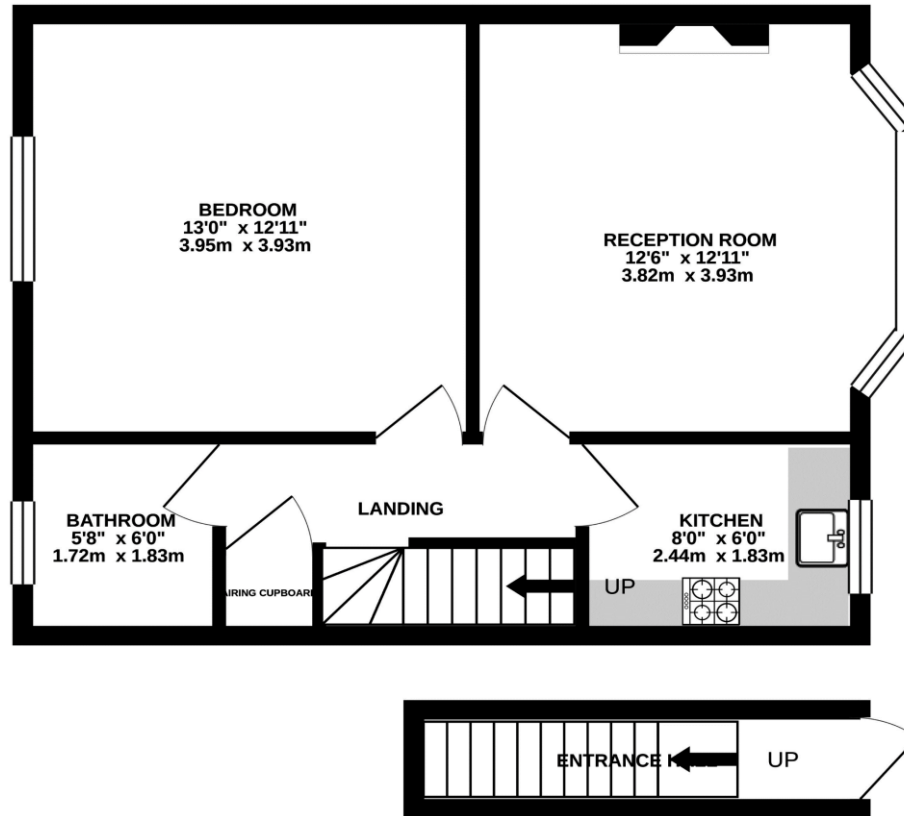

TOTAL FLOOR AREA: 501 sq.ft. (46.5 sq.m.) approx.

Whilst every attempt has been made to ensure the accuracy of the floorplan contained here, measurements of doors, windows, rooms and any other items are approximate and no responsibility is taken for any error, omission or mis-statement. This plan is for illustrative purposes only and should be used as such by any prospective purchaser. The services, systems and appliances shown have not been tested and no guarantee as to their operability or efficiency can be given.  
Made with Metropix ©2021

# Location

Located only half a mile away from Motspur Park station, which is on the London Waterloo line

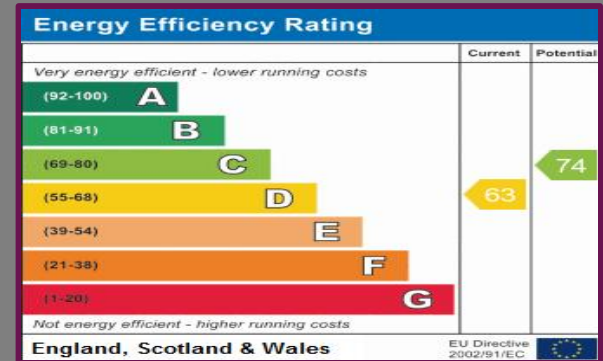

We aim to make our particulars both accurate and reliable but they are not guaranteed, nor do they form part of an offer or contract. If you require clarification of any points then please contact us especially if you are travelling some distance to view. Please note that appliances and heating systems have not been tested and therefore no warranties can be given as to their good working order.



A refreshing choice...

COBHAM: 13 Oakdene Parade, Cobham, Surrey, KT11 2LR

Tel: 01932 864242 | Email: cobham@bourneestateagents.com

Web: www.Bourneestateagents.com