



ESTATE AGENTS



Flat 8, Twickenham Place, 69 Woodfield

£250,000

Super one bedroom ground floor flat, situated in a quiet residential location and within less than 0.5 miles of Hinchley Wood and Esher stations.

13 Oakdene Parade, Cobham, Surrey, KT11 2LR
Tel: 01932 864242 | Email: cobham@bourneestateagents.com
w: bourneestateagents.com

GROUND FLOOR

437 sq.ft. (40.6 sq.m.) approx.

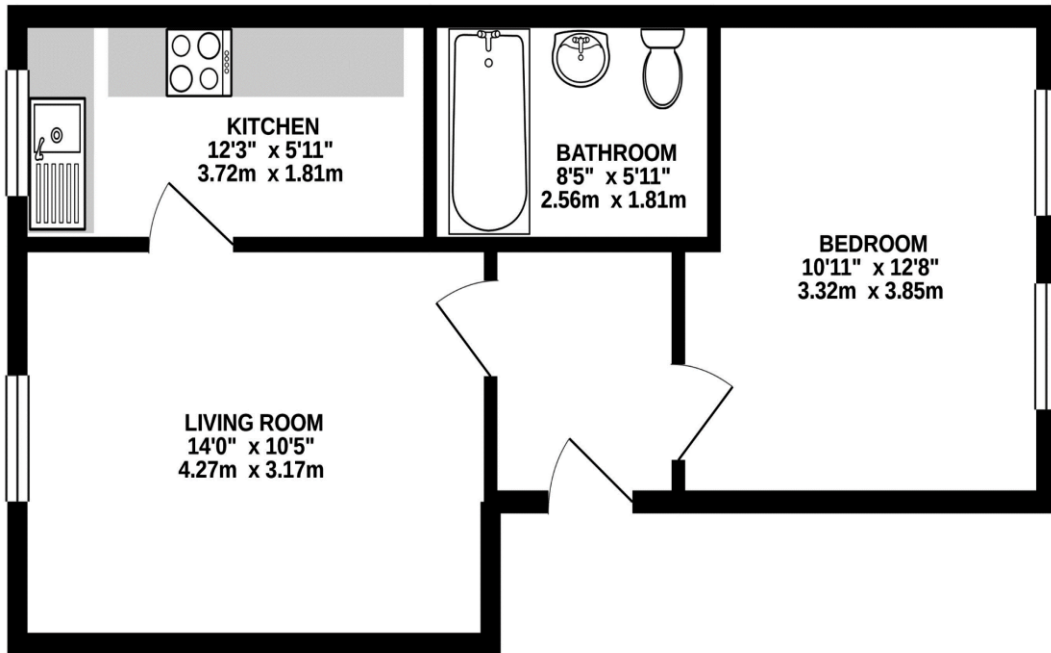

TOTAL FLOOR AREA : 437 sq.ft. (40.6 sq.m.) approx.

Whilst every attempt has been made to ensure the accuracy of the floorplan contained here, measurements of doors, windows, rooms and any other items are approximate and no responsibility is taken for any error, omission or mis-statement. This plan is for illustrative purposes only and should be used as such by any prospective purchaser. The services, systems and appliances shown have not been tested and no guarantee as to their operability or efficiency can be given.
Made with Letrotools 21/2021



Energy Efficiency Rating		
	Current	Potential
Very energy efficient - lower running costs		
(92+) A		
(81-91) B		
(69-80) C	78	79
(55-68) D		
(39-54) E		
(21-38) F		
(1-20) G		
Not energy efficient - higher running costs		
England, Scotland & Wales	EU Directive 2002/91/EC	

We aim to make our particulars both accurate and reliable but they are not guaranteed, nor do they form part of an offer or contract. If you require clarification of any points then please contact us – especially if you are travelling some distance to view.