



ESTATE AGENTS



Meadow Court, Anchor Meadow, Farnborough, Hampshire,
GU14 0HX

Asking Price £235,000

Meadow Court, Anchor Meadow, Farnborough, Hampshire, GU14 0HX

This ground floor apartment boasts a modern and elegant design, offering comfortable living in a newly refurbished space.

Featuring two spacious double bedrooms, it presents ample room. The interior showcases contemporary finishes and fixtures, enhancing the overall ambiance.

Additionally, residents can enjoy the benefits of communal grounds.

Leasehold

Service Charges: £430 Every Six Months

Service Charge Review Period: Annually

Annual Ground Rent: £150

Ground Rent Review Period: Annually

Years Remaining on Lease: 103 years

- Ground Floor
- Two Double Bedrooms
- Recently Refurbished
- Living Room
- Kitchen
- Communal Gardens
- Underfloor Heating
Throughout
- Council Tax Band: C



Meadow Court, Anchor Meadow, Farnborough, GU14

Approximate Area = 693 sq ft / 64.3 sq m

For identification only - Not to scale

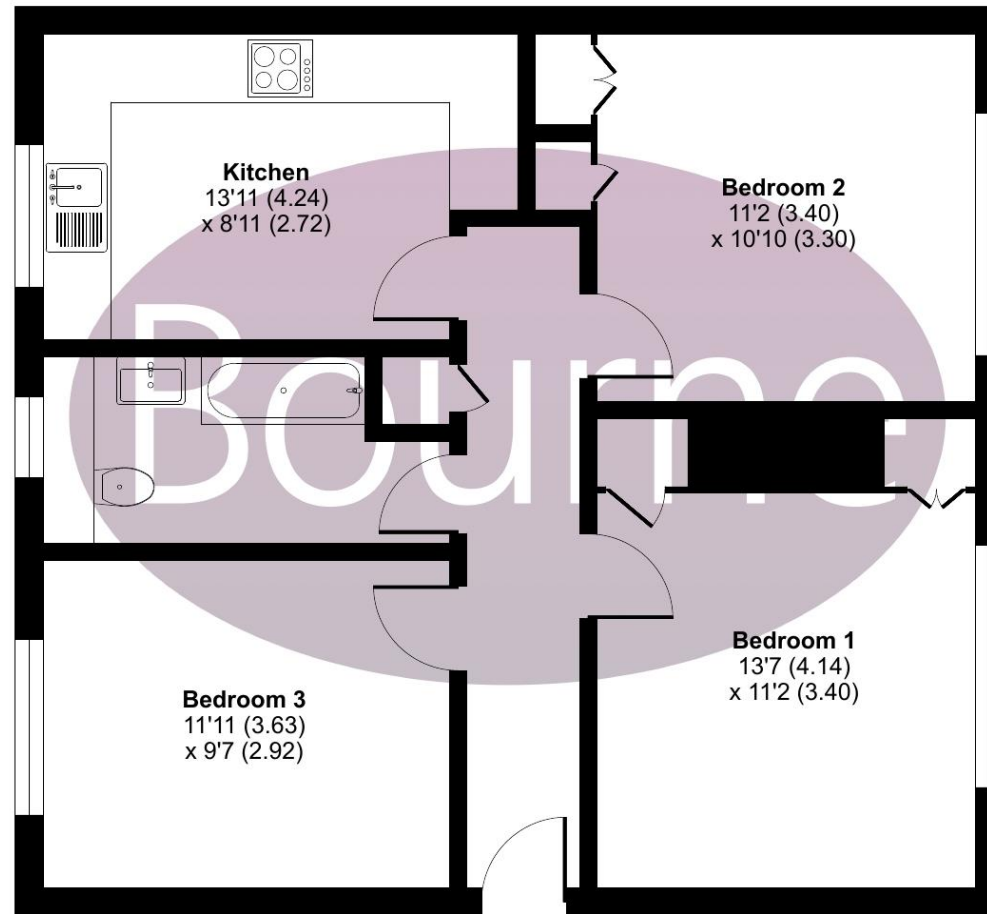

GROUND FLOOR



Floor plan produced in accordance with RICS Property Measurement Standards incorporating International Property Measurement Standards (IPMS2 Residential). © nitchecom 2024. Produced for Bourne Estate Agents. REF: 1109887

Location

Situated in a friendly and well-established neighbourhood, this house is conveniently located close to schools, parks, shops, and public transportation options, providing easy access to all essential amenities.

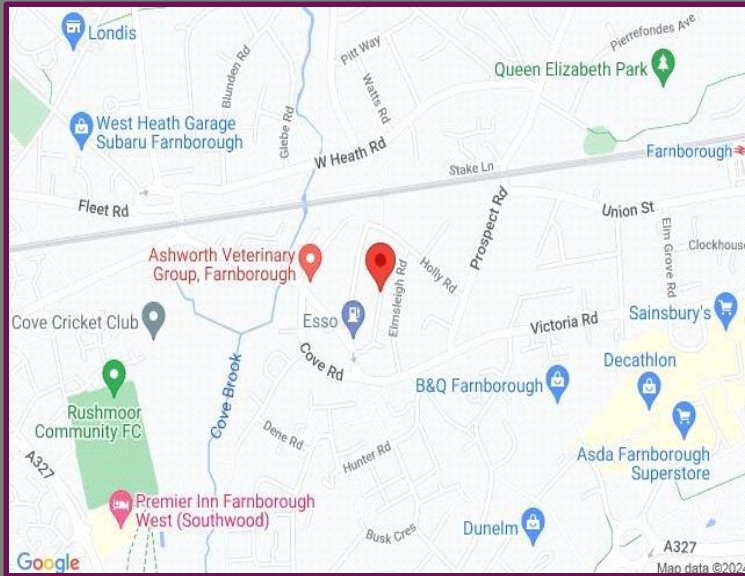

Energy Efficiency Rating		Current	Potential
Very energy efficient - lower running costs			
(92+)	A		
(81-91)	B		
(69-80)	C		74
(55-68)	D	61	
(39-54)	E		
(21-38)	F		
(1-20)	G		
Not energy efficient - higher running costs			
England, Scotland & Wales		EU Directive 2002/91/EC	

We aim to make our particulars both accurate and reliable but they are not guaranteed, nor do they form part of an offer or contract.

If you require clarification of any points then please contact us especially if you are travelling some distance to view.

Please note that appliances and heating systems have not been tested and therefore no warranties can be given as to their good working order.



A refreshing choice...

ASH VALE: 244 Shawfield Road, Ash Vale, Surrey, GU12 5DJ

Tel: 01252 560838 | Email: ashvalesales@bourneestateagents.com

Web: www.Bourneestateagents.com